

# TESLONG

## Inspection Camera User Manual

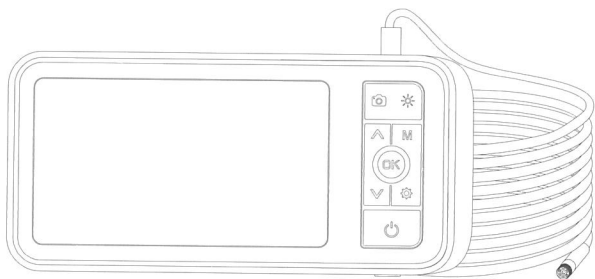

Model No.: MS450-NTC

### ■ Product Manual

MS450-NTC is a high performance industrial endoscope with a 4.5-inch high definition color screen. It is ergonomically designed so that users can control the main buttons with just 1 hand. The snapshot and recording functions are supported; photos and videos can be saved on TF memory card ( Micro-SD card). This product is equipped with an LED-assisted illumination and small-diameter HD camera. The camera uses a high-sensitivity chip to help this product perform in the dark.

The camera probe is interchangeable, it can connect to different probes with different sizes, dimensions, angles, or focal lengths.

**!** Warning: This product is an industrial endoscope camera and is not intended for medical use or human examination.

### ■ Safety and Maintenance

- DO NOT violently hit the camera probe, DO NOT imprudently pull the cable. When used in the environment with sharp objects, be extra careful to prevent the probe's waterproof protective layer from being scratched during usage.
- The camera probe materials are not resistant to high temperature. When checking the vehicle engine, please ensure that temperature inside the engine is at the normal temperature.
- This product is not suitable for people with limited physical, sensory or mental capabilities.
- DO NOT allow children to touch or operate this device.
- In case the device is damaged, DO NOT disassemble it by yourself. Please contact the seller or the agent where you bought it to get repair service.

### ■ Battery Description

- Please use 5V household charger that meets safety regulations to charge this device.
- If you do not use the device for a long time, please ensure that it is charged at least once every 3 months to prevent irreparable damage caused by excessive battery discharge.

## ■ Functions

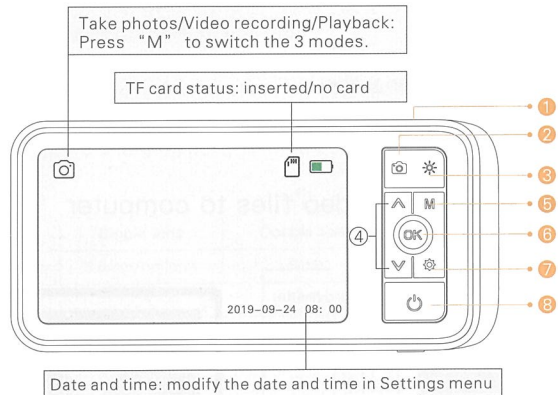

- 1 Camera probe connector.
- 2 Snap: Take photos/start or end video recording.
- 3 Light control: To adjust the the LEDs brightness of the camera.
- 4 Up and down selection button / Zoom in / Rotate 180°.
- 5 Mode: Take Photos, video recording & playback.
- 6 Enter: Confirm selection/freeze screen.
- 7 Settings: Enter or exit settings menu.
- 8 Power: Press and hold for a few seconds to turn ON/OFF .

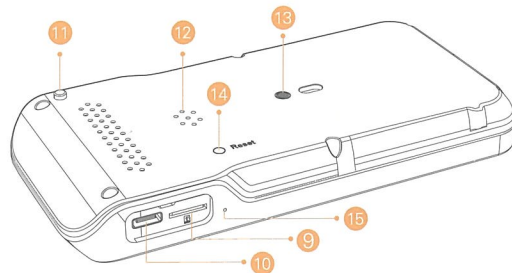

- 9 TF card slot
- 10 Charging port
- 11 Camera probe lock (Press this button to unlock and pull out the camera probe)
- 12 Speaker
- 13 Installation hole of Screen bracke
- 14 Reset
- 15 Microphone

### Take Photos



Press **[M]** to switch to the take photos , and press **[📷]** to take a photo.

### Video Recording



Press **[M]** to switch to video recording mode, press **[📹]** to start recording.

## ■ Instructions

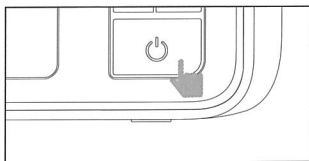

Press & hold the Power button for a few second to turn ON/OFF device.

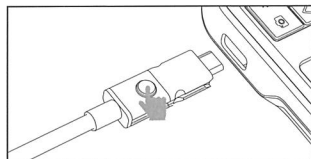

Notice: Press this button to switch the front and side lenses. When connecting a dual lens camera probe.

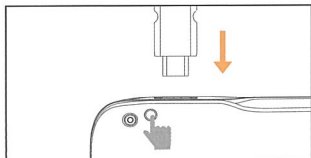

Press this button then pull out the Type-C plug of the probe from the monitor.

**Note:** Connect camera probe then turning on device. Restart device if replacing camera probe.

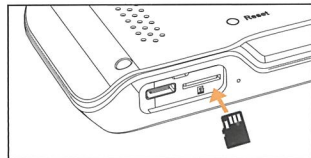

The device is equipped with a TF memory card(inserted). Gently press to eject the card.

## ■ How to insert TF card:

- Power off device first before insert TF card.
- Make sure the direction and the front and back sides is correct when insert the TF card.
- Do not use excessive pressure when inserting or removing the TF card to prevent damages of card slot structure.
- You can only take photos or recording videos when a TF card is inserted in the device.

## ■ Language Settings

The default language is English, and the system supports English, Chinese, German, French, Spanish, Italian, Russian, and Japanese.

Setting path:

Press the  button twice to enter setting page.

Select second item (Language).

Press up and down to select the language you need.

Press  to save your choice.

## ■ Copy photo and video files to computer

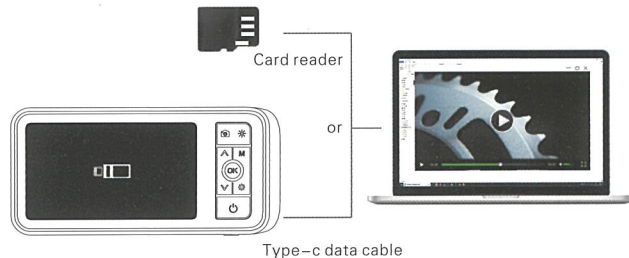

You can use a TF card reader to copy data directly or use a type-C cable to connect to a computer for copying.

## ■ Specification Parameters

### Screen

Screen: 4.5-inch HD Display

Screen resolution(Pixels): 854x480

Support probe resolution(Pixels): 1.0 Megapixel HD

Image Capturing resolution(Pixels): 1920x1080

Video Recording resolution(Pixels): 1280x720

Port: Type-C charging port, TF memory card slot

### Camera

	Single lens	Double lens	Three lens
Diameter	5.5mm/optional	8mm	7.9mm
Length	Optional		
Resolving power	100W Pixel		
Angle	70°	70°	78°±3°
Auxiliary lighting	6 adjustable brightness LED lamps	6 + 1 adjustable brightness LED lamps	6 + 1 + 1 LED lights with adjustable brightness
Focus Range	Main lens 30-100mm	Main lens 30-80mm Side lens 20-50mm	Main lens 30-100mm Side B lens 20-60mm side C lens 15-30mm

### Others

Operating Temperature: 32°F to 113°F (0°C to 45°C)

Power Source: 2500mAh Lithium Battery

Working Time: 3-4 hours

Charging Time:3-4 hours

### Packaging

Monitor, camera probe, Type-C charging cable, user manual, screen bracket

Accessories-pick up hock, magnet, mirror

(Note: 3.9mm NO accessories)



## Customer Service

Please contact us if you have any product quality problems, we would love to hear from you.



Manufacturer Service



support@teslong.com | info@teslong.com



1-877-899-8809 (US)  
(Mon-Fri 8:00 AM-5:00 PM PST)



© TESLONG MS450.-NTC 202109 V1  
3.06.02.000216